

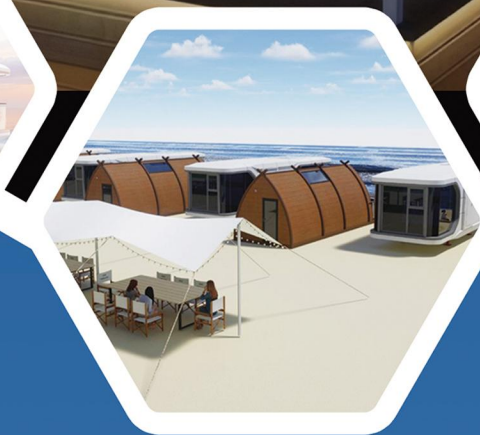

# SPACE CAPSULE

A Journey Through Time And The Future

Space capsule products are widely used in urban business, cultural and tourism scenic spots, theme parks, cultural and creative industrial parks, cultural and tourism towns and other fields.



**BOOK NOW**



Contact Us  
[sales@aleader-china.com](mailto:sales@aleader-china.com)

Visit our website  
[www.aleader-china.com](http://www.aleader-china.com)



# W5-SERIES

SPACE CAPSULE 8.5M



Product Dimensions (mm)

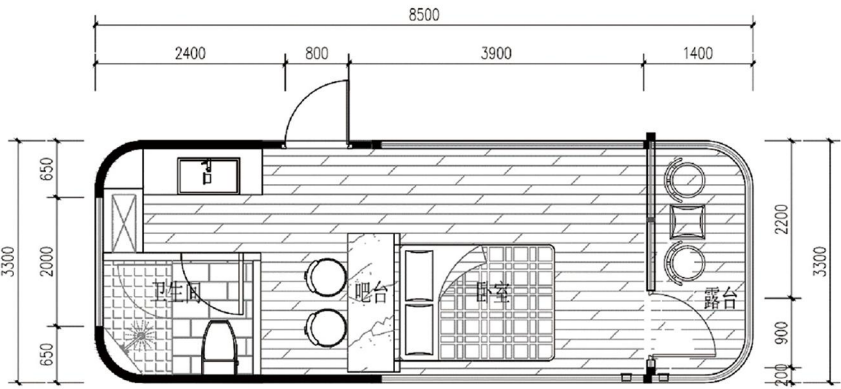

Interior Layout



Product Model

Model	Dimensions	Building Area	Room Type	Rated Power
W5	L: 8500mm W: 3300mm D: 3300mm	28.00 m <sup>2</sup>	1-2 People	10KW (without floor heating) /15KW (with floor heating)



# W7-SERIES

SPACE CAPSULE 11.5M



Product Dimensions (mm)

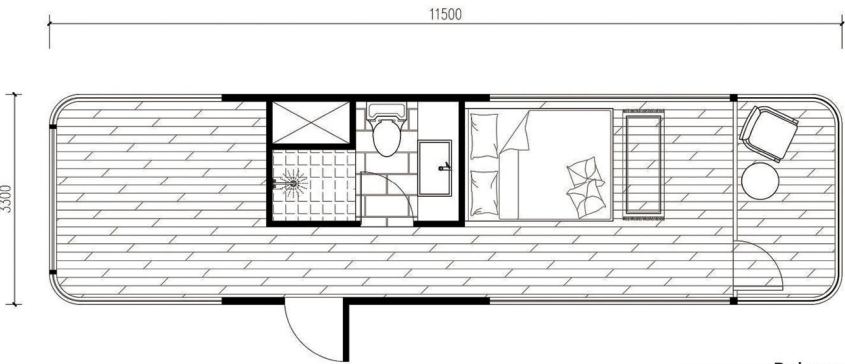

Interior Layout

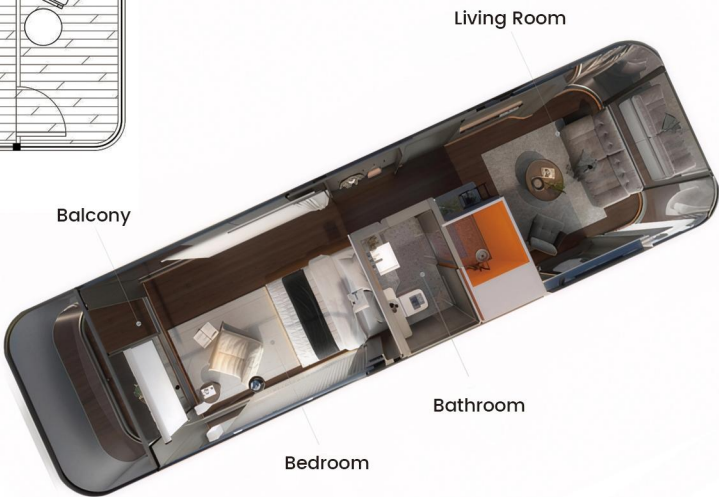

Product Model

Model	Dimensions	Building Area	Room Type	Rated Power
W7	L: 11500mm W: 3300mm D: 3300mm	37.95 m²	2-4 People	10kW (without floor heating) /15kW (with floor heating)

# W9-SERIES

SPACE CAPSULE 11.5M

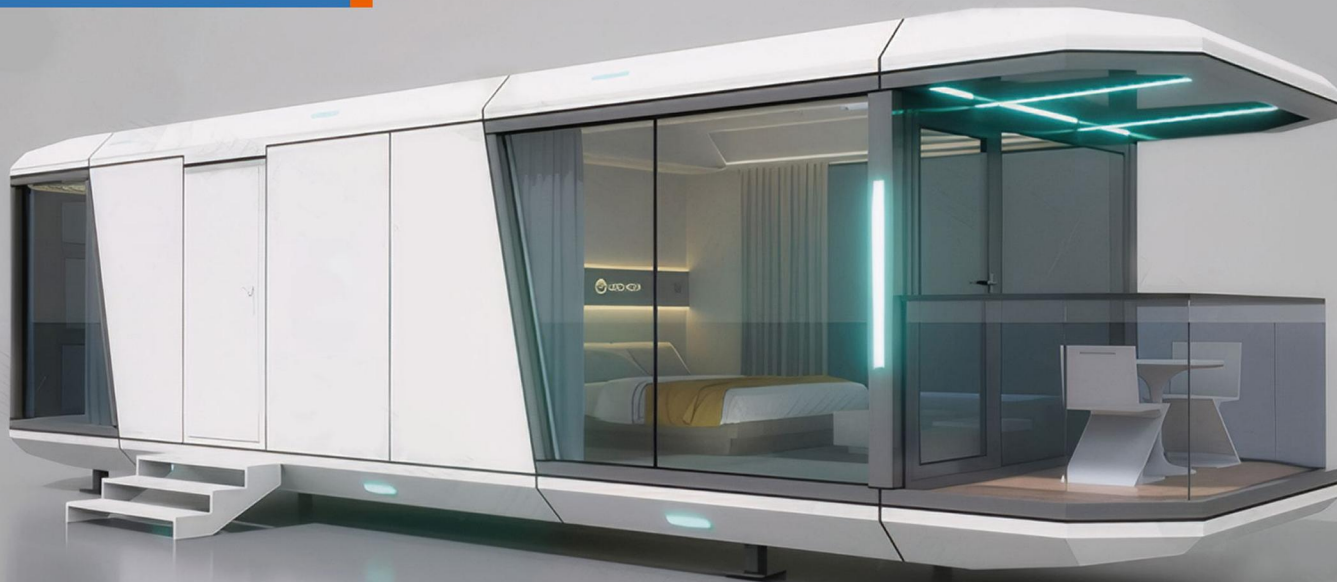

Product Dimensions (mm)

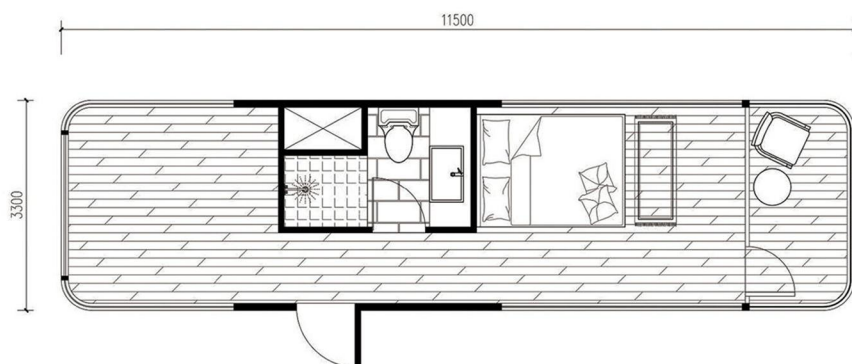

Interior Layout

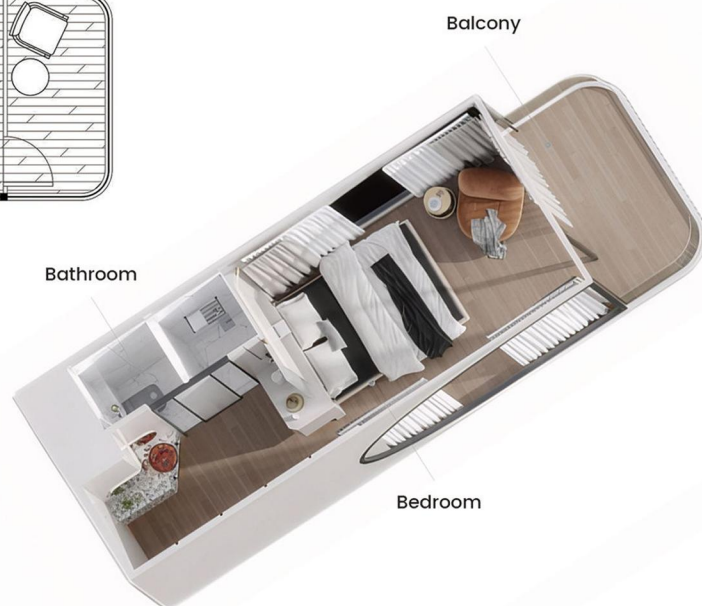

Product Model

Model	Dimensions	Building Area	Room Type	Rated Power
W9	L: 11500mm W: 3300mm D: 3300mm	37.95 m <sup>2</sup>	2-4 People	10KW (without floor heating) /15KW (with floor heating)

# W11-SERIES

SPACE CAPSULE 9.0M

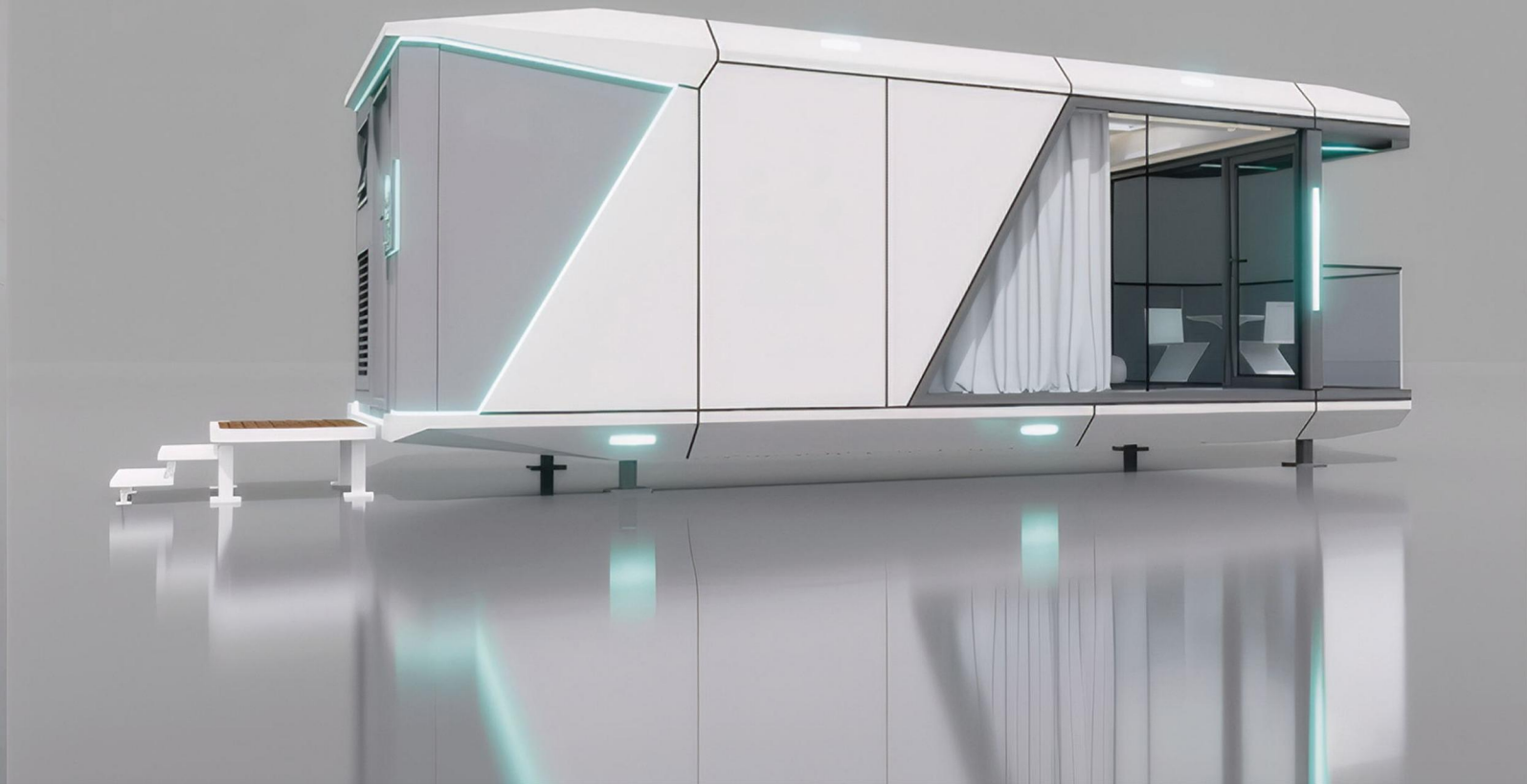

Product Dimensions (mm)

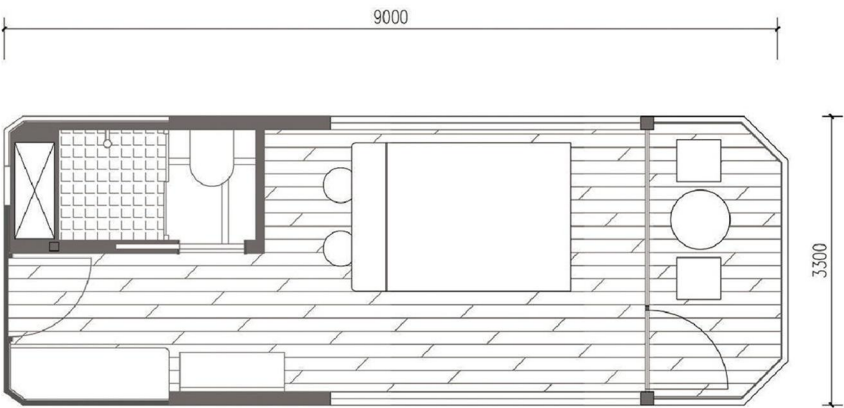

Interior Layout



Product Model

Model	Dimensions	Building Area	Room Type	Rated Power
W11	L: 9000mm W: 3300mm D: 3300mm	29.70 m <sup>2</sup>	1-2 People	10kW (without floor heating) /15kW (with floor heating)





# CO8-SERIES

A ROUND SPACE CAPSULE 7.5M



Product Dimensions (mm)

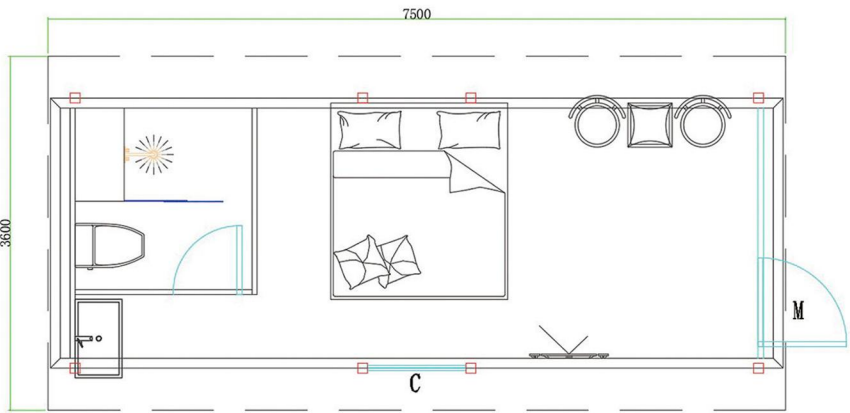

Product Model

Model	Dimensions	Building Area	Room Type	Rated Power
CO8	L: 7500mm W: 3600mm D: 3100mm	27.00 m <sup>2</sup>	1-2 People	10KW (without floor heating) /15KW (with floor heating)

Interior Layout



## SPACE CAPSULE STANDARD CONFIGURATION DETAIL

Item	Contents	
Refined Decoration	Main Body Frame System	Anti-seismic Galvanized Steel Frame Structure
	Exterior Wall System	All Aluminum Custom Aluminum Veneer +(metal fluorocarbon paint)
	Door and Window System	Broken Bridge Aluminum (6+12A+6 hollow LOW E tempered glass) Electric Curtain
	Glass Curtain Wall System	Glass Curtain Wall (6+12A+6 hollow LOW E tempered glass)
	Thermal Insulation System	Thermal Insulation Waterproof Layer (polyurethane insulation layer)
	Ceiling System	Standard Color Ceiling Carbon Crystal Large Plate
	Skylight System	Starry Roof (skylight) + Electric Blinds
	Wall system	Standard Color Wall Decoration Panel
	Ground System	Base Floor Panel + Indoor Environmental Protection Composite Wood Floor
	Entry Door System	Entry Door Hotel Outdoor Waterproof Intelligent Door Lock
	Equipment Room System	Equipment Room (all aluminum custom louver door)+ Electrical Appliances (air conditioning and water heater)
	Atmosphere System	Peripheral Lights (three-dimensional atmosphere lights)
	Supporting Transportation and Safety System	Foot Braces/Lifting Lugs/Transport Fixings/Installation Fittings
Electric Appliance Configuration	Intelligent Control System	Whole House Lighting, Curtains, Voice Intelligent Control System
	Electrical Control	Safety Flame Retardant Wire
	Waterway Circuit	Reserved Indoor Water Supply and Electrical Pipeline Power Supply
	Heating and Cooling Air Conditioning	Hisense Air Conditioning 2P
	Water Heater	Brand Water Heater
	Shower Heater	Lighting Heating Blower Exhaust Four-in-one
	Bedroom Lighting	Downlight
	Bedroom Atmosphere Light	With Atmosphere Light Belt
Bathroom Configuration	Bathroom Door	Titanium Magnesium Alloy Changhong Privacy Door
	Washbasin	Panel/Plate/Mirror/Cabinet/Floor Drain (custom)
	Toilet	Brand Toilet
	Faucet	Brand Faucet
	Shower	Brand Shower
	Floor	Non-slip Waterproof Ground

Note: The above is the product standard (excluding the optional part)  
Product continuous upgrading, the picture is for reference only, the final delivery of the product shall prevail.



# MULTI-CONTAINER LOAD

MULTI-CONTAINER LOAD



## Product Introduction

The appearance of multi-container is similar to the packaging box, which is folded on the basis of the packaging box. Compared with the traditional folding box, it is more beautiful and atmospheric, and has better tightness and longer life.

Multi-container load Size:  
2990mm x 6000mm x 2800mm



## Product Features

1. Integrated folding design, airtight.
2. Built-in drainage system, waterproof.
3. Reinforced base structure ensures flat, vibration-free flooring.
4. Concealed wiring with quick-connect sockets for safe power use.





# ENCLOSURE FENCE

ENCLOSURE FENCE



## Product Introduction

Enclosure fence used to isolate construction sites from external environments, creating enclosed spaces. Materials include masonry walls or prefabricated panels. They enhance aesthetics, cleanliness, and uniformity in urban projects. Standard heights range from 2m to 12m. Surfaces often display project visuals, promotional content, or public service ads.

